

33'
Extendable
Bridgemaster
Chassis

Run . .with the **Best**



3rd & Oak Streets
P.O. Box 388
Berwick, PA 18603
Tel 844-205-5525
www.cheetahchassis.com



33' Extendable Bridgemaster Chassis

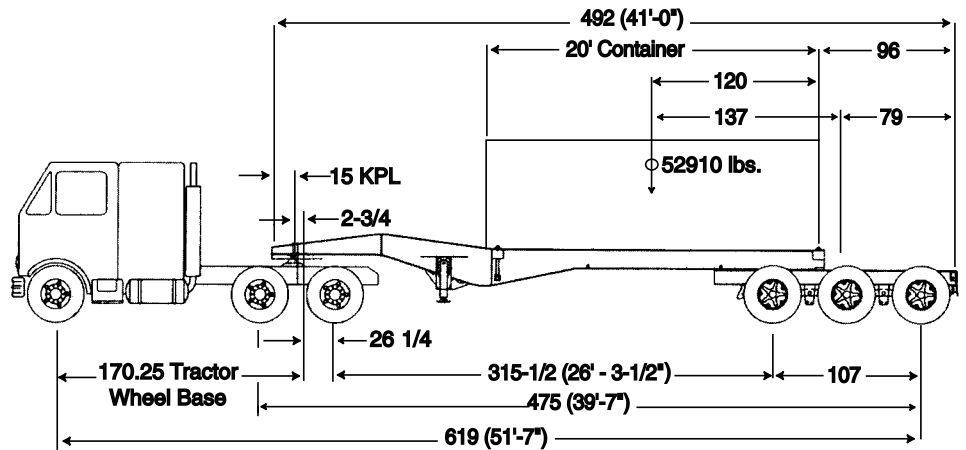

Standard Specifications

Function:

Carries one (1) 20' container rated for 24 metric tons when using a 16,200 lb. tractor. Meets all DOT and FMVSS regulations in effect at the time of manufacture and applicable to operation in the United States.

*Run . . .
with the Best*

JOHN FULENWIDER, RSM
Cell: (972) 978-7120
Email:
jfulenwider@cheetahchassis.com

Specifications subject to constant engineering design improvements.

Overall Length Extended: 41'
Overall Length Closed: 33'
Tri-axle Location: 79" to center axle.
King Pin Location: 15"
Pick-up Plate Height: 48"
Dock Height: 52"
Overall Bolster Width: 96"
Overall Tire Width: 102"
Slide Range: 96"
Main Beams: Fabricated I-beam section with 3/8" x 6" Grade 80 top and bottom flanges and 1/4" web. Tapered front and rear, maximum depth 26 1/2".
Bogie Beams: Wide flange I-beam, W10 x 30#/ft.; ASTM A572 Grade 65.
Crossmembers: Formed from 7 gauge (.180) hi-tensile low alloy steel.
Upper Coupler Assembly: 1/4" thick pick-up plate; crosshead style king pin. Channel reinforcements fore and aft of pin.

Front & Rear Bolsters: Tube type, 6" x 8" with 1/2" end plates.

Twist Locks: Meets ISO standards and requirements.

Bumper: 4" x 4" x 3/16" tube step bumper. Two rubber dock bumpers.

Landing Gear: Two speed AAR approved, square leg, 55,000 lbs. lift capacity and 160,000 lbs. static load capacity. Roadside crank handle. 10" x 10" low profile sandshoe.

Slider Mechanism: Two (2) spring loaded forged steel pins penetrate and engage with reinforced web of main frame. Movement facilitated by low friction slide pads.

Suspension: Tridem undermount unit with mono leaf springs. U-bolt nuts facing down. 53-1/2" axle spacing.

Rims/Wheels: 8.25 X 22.5 hub piloted tubeless. Painted white.

Tires: IIR 22.5

Axles: 5" round, Nominal 25,000 lb. capacity. Non-asbestos brake lining and quick change feature. All axles have cams to the rear and push rods under. HM series bearings.

Lubrication: Synthetic grease.

Slack Adjusters: Automatic.

Brakes: Three tank, three valve system. Wabco 2S/1M ABS control valve with diagnostics and Sealco #110800 spring brake valve. 30/30 brake chambers.

Electrical System: 12V, 7-way split pin receptacle plug; modular wiring harness.

Lights: Flange mounted.

Metal Preparation: Clean, dry steel and NACE No. 3/SSPC-SP-6 "Commercial Blast Cleaning".

Paint/Top Coat: 70% Zinc rich primer. Black urethane.

Markings: FMCSA plate and tare weight, 2 small Cheetah logos.

Mud Flaps: 18" x 24" white plastic, 4 hole mounting.

Steel & Fasteners: Structural steel is ASTM A-572, Grade 50 or ASTM A607, Grade 50 unless specified other-wise. Structural fasteners are Grade 5 or better and zinc plated for corrosion resistance.

GVWR: 65,000 lbs.

Estimated Weight: Approx. 10,800 lbs. +/- 3%.